



SENA[®]

SHIP MANAGEMENT S.A

M/V SEA WAVE 1

8420426

**VESSEL
PAMPHLET**



25 Reda Street, ADAM bldg. 4th Floor, Ismailia-Egypt.
Tel: +201033050011 | +20643135910
Info@senashipping.com
www.senashipping.com



VESSEL NAME	: SEA WAVE 1
VESSEL TYPE	: RO-RO CARGO SHIP
FLAG	: PANAMA
REGISTRION NO	: 54655-PEXT
PORT OF REGISTRY	: PANAMA
CALL SIGN	: HOA4720
MMSI	: 352001252
IMO NUMBER	: 8420426
YEAR BUILT	: 1987
PROPULSION	: PITCH PROPELLER - BERG TYPE 900 H 4 DIAMETER 3.2 MTS
CLASS SOCIETY	: RINA
CLASS NOTATION	: RO-RO CARGO SHIP; UNRESTRICTED NAVIGATION
CLASS ID	: RINA 66215
BUILDER	: CANTIERI NAVALI VISENTINI - DONADA, ITALY
OWNER	: BAHR AL KHAIR MARITIME CORPORATION
MANAGER	: SENA SHIP MANAGEMENT S.A.
P & I CLUB	: AMERICAN CLUB
H & M CLUB	: AL-BAHRIAH INSURANCE & REINSURANCE S.A.L

SHIP PARTICULARS:

LENGTH OVERALL (M).	: 125.25
LBP (M).	: 111.90
DEPTH MOULDED (M).	: 11.75
BREADTH OVERALL (M).	: 19.70
FREEBOARD, SUMMER (M)	: 7.00
DRAUGHT, SUMMER (M)	: 4.75
DISPLACEMENT (TONS).	: 6,872
DEAD WEIGHT "S" (TONS)	: 4,080
GROSS TONNAGE (TONS)	: 7,095
NET TONNAGE (TONS)	: 2,128
LIGHT SHIP (TONS)	: 2,834
HEIGHT (FROM KEEL TO ANT) (M)	: 37.5
MARINE DIESEL OIL (CBM)	: 450
FRESH WATER (CBM)	: 212
WATER BALLAST (CBM)	: 2,562
SPEED AT SCANTLING DRAFT (KNTS)	: 12.5 KNTS

PROPULSION PARTICULARS:

MAIN ENGINE	: Wartsila 16 Cyl 2990 kw ; NOHAB F 316B ; MGO Density max 0.90
AUX. ENGINE	: DEUTZ BA 8M 816 3 x 300 KW + 1 Emergency generator
BOW THRUSTER	: 1 X 400 KW

CARGO HOLDS CAPACITY:

CONTAINER HOLD + CAR DECK	: 155 TEUS + 58 CARS
CONTAINER ON DECK	: 192 TEUS
TOTAL CONTAINERS	: 347 TEUS
TOTAL TRAILER DECK / HOLD	: 38 / 37
CAPACITY HOLD / CARDECK	: 12337 / 1754 CBM
FREE HEIGHT HOLD/CARDECK	: 6.1 M / 2.6 M
REEFER CAPACITY DECK/HOLD	: 9/4 PLUGS
STACKWEIGHT DECK	: 20`/40`= 26 m 2 Tiers maxi
STACKWEIGHT HOLD	: 20`/40`= 27 m 2 Tiers maxi
IMO CARGO	: As per DOC for IMO CARGO
CARGO GEAR	: Elevator max 6 Tons capacity

LOWER DECK (CAR DECK): $4 \text{ M} \times 8.8 \text{ M} = 35.2 \text{ M}^2$
 $44 \text{ M} \times 10 \text{ M} = 440 \text{ M}^2 - 9 \text{ M}^2 = 431 \text{ M}^2$
 $9.4 \text{ M} \times 5.9 \text{ M} = 55.4 \text{ M}^2$
 $2.6 \text{ M} \times 10 \text{ M} = 26 \text{ M}^2$
TOTAL = 547.6 M²

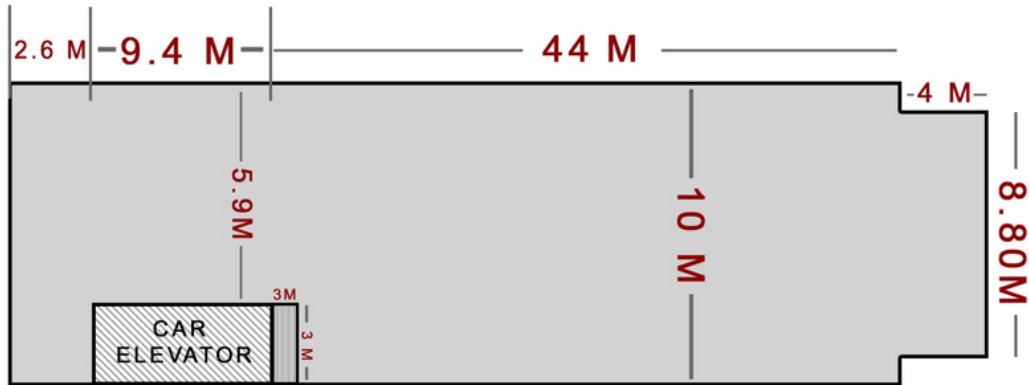

MAIN GARAGE: $15 \text{ M} \times 6 \text{ M} = 90 \text{ M}^2$
 $50 \text{ M} \times 17 \text{ M} = 850 \text{ M}^2$
 $26.5 \text{ M} \times 8 \text{ M} = 212 \text{ M}^2$
 $4.5 \text{ M} \times 6.5 \text{ M} = 29 \text{ M}^2$
TOTAL = 1,181 M²

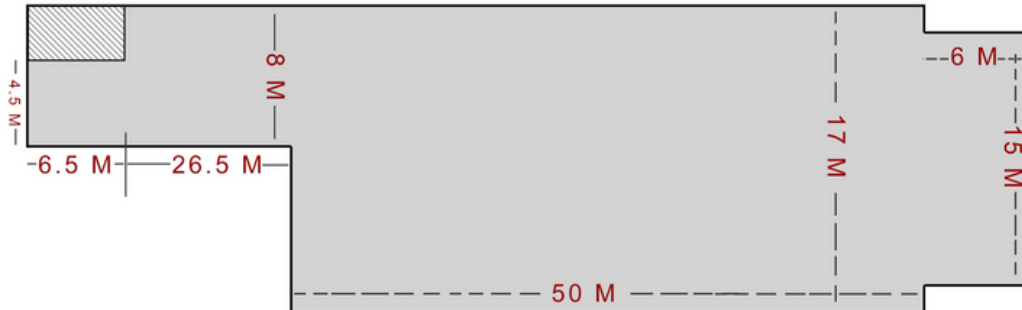

WEATHER DECK $15 \text{ M} \times 15 \text{ M} = 225 \text{ M}^2$
 $18 \text{ M} \times 47 \text{ M} = 846 \text{ M}^2$
 $8.5 \text{ M} \times 12 \text{ M} = 102 \text{ M}^2$
TOTAL = 1,173 M²

